

- Sizes :** 1" bis 10"
- Pressure:** ANSI 1500 LB
- Flanges:** ASME B16.5 - RF
- Features:**
- Integrally cast housing
 - Bolted cover c/w drain plug
 - Red oxide finish (Carbon Steel only)
 - Ø 3 mm perforated hole plate as standard
- Advantages:**
- Largest filtration area on the market
 - Very low pressure losses dp
 - Extended cleaning intervals
 - European design
- Options:**
- Special screens and special gaskets
 - Cover safety cowls
 - D.P. tappings / gauge / transmitter
 - Magnetic screen insert
 - Flanged drains / drain valves /
 - Special finish/linings
- Standards:** PED 2014/68/EC
CE-Marking
EN 10204 Certification
NACE-Certification

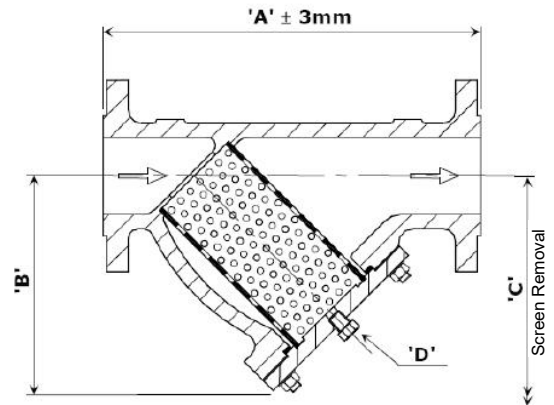

All data is subject to confirmation at the time of order. Our policy is one of continual improvement and we reserve the right to amend details without prior notice.

Technical Data

Size		Dimensions				Screen Area [cm ²]	Weight (kg)
mm	inch	A	B	C	D (NPT)		
15	½"	295,0 (340,0 optional)	190,0	225,0	½"	80,0	15,0
25	1"	340,0	190,0	225,0	½"	164,0	21,0
40	1½"	415,0	210,0	255,0	½"	327,0	45,0
50	2"	415,0	210,0	255,0	½"	327,0	45,0
80	3"	495,0	245,0	295,0	½"	532,0	139,0
100	4"	655,0	335,0	415,0	½"	905,0	148,0
150	6"	935,0	492,0	610,0	½"	2150,0	516,0
200	8"	1085,0	630,0	725,0	½"	3790,0	895,0
250	10"	1320,0	745,0	920,0	½"	4830,0	1220,0

Material

Item	Carbon Steel	Stainless Steel
Strainer Body	ASTM A216 WCB (~1.0619 Cast)	ASTM A351 CF8M (~1.4408)
Strainer Cover*	BS 1501 151 430A	BS 970 316 S31
Drain Plug	ASTM A105N (~1.0460)	ASTM A182 F316 (~1.4404)
Cover Stud Bolts	ASTM A193 B7 (~1.7225) – zinc plated	ASTM A193 B7 (~1.7225) – zinc plated
Retaining Nuts	ASTM A194 2H (~1.7225)- zinc plated	ASTM A194 2H (~1.7225) – zinc plated
Cover Gaskets	Spiral Wound ST.ST. 316 / C.N.A.F. (as Standard / to Customer Specification)	
Plain Washers	Steel – zinc plated	
Screen (perforated)	ST.ST. 316 (~1.4404) (Ø 3 mm perforated hole plate as standard / to Customer Specification)	

*The strainer cover may be furnished from plate or casting depending upon size and availability.

Model Number Derivation : A* / R150 / *** / YHD**

Denotes the size, i.e. add 025 for a 1"

216 denotes Carbon Steel
351 denotes Stainless Steel (A351 CF8M)